

Model : ALP7575-R

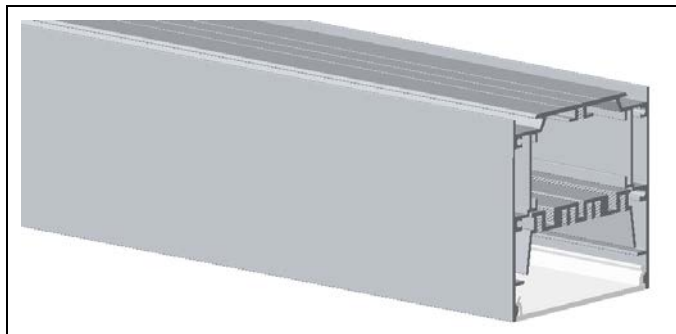

Dimension

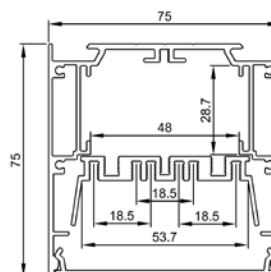

Specification

Aluminum Profile	6063-T5
Diffuser	PC diffused cover
Length	2000mm / 2500mm / 3000mm
Weight	2.589kg/m
Max LED Strip Width	52mm
Max Power	40W/m
Beam angle	100°
Finish	Silver / Black anodized , Powder coated white / black or other colors
Installation	Pendant / Surface

Accessories

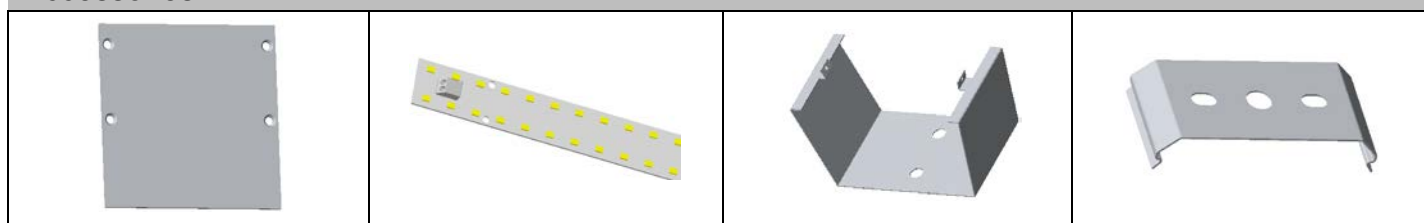

Magnet End Cap (Metal)

LED Strip

Inside Clip

Outside Clip

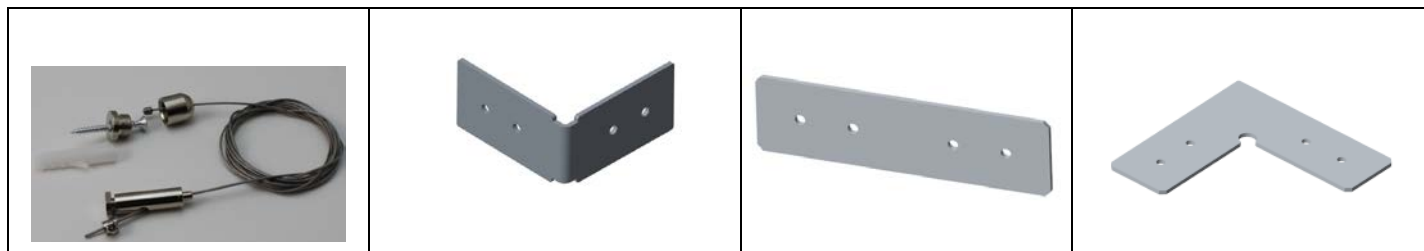

Hanging Cord

90° vertical connector

180° connector

90° connector

Steps of Installation

1. Fix the led module with screws

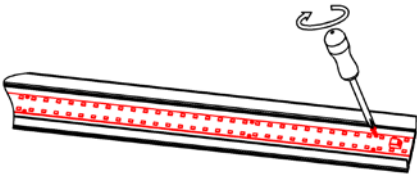

2. Fix the driver & inside clips with screws

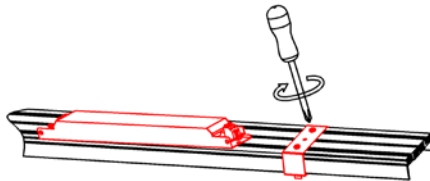

3. Press the assembled part into profile

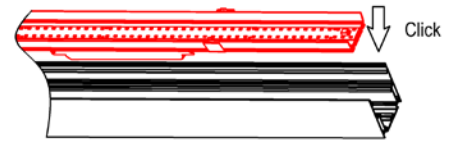

4. Click the diffused cover

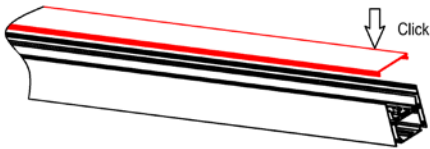

5. Fix the end caps with screws

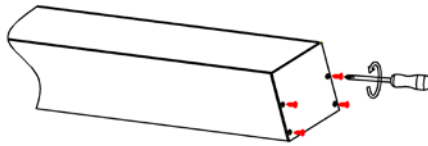

6. Install the outside clip for suspension.

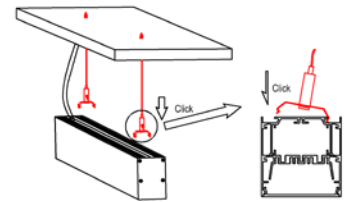

7. Adjust the suspended cord parts .

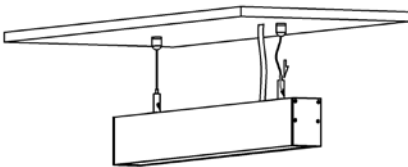

Model : ALP7575-RD

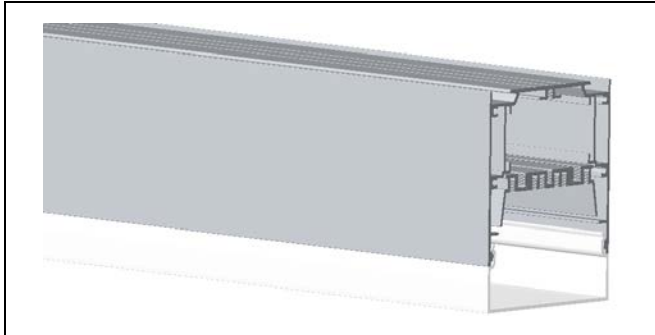

Dimension

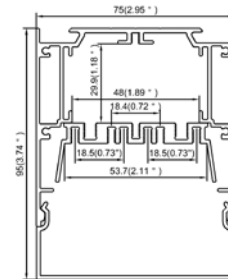

Specification

Aluminum Profile	6063-T5
Diffuser	PC diffused cover
Length	2000mm / 2500mm / 3000mm
Weight	2.636kg/m
Max LED Strip Width	52mm
Max Power	45W/m
Beam angle	100°
Finish	Silver / Black anodized , Powder coated white / black or other colors
Installation	Pendant / Surface

Accessories



Magnet End Cap (Metal)



LED Module

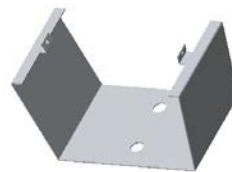

Inside Clip



Outside Clip



Hanging Cord



Safety Cable

Steps of Installation

1. Fix the led module with screws

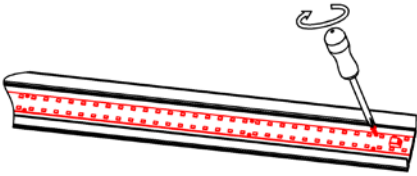

2. Fix the driver & inside clips

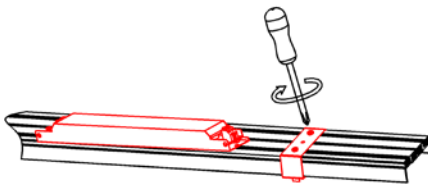

3. Click the assembled part into profile

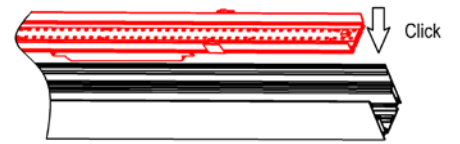

4. Click the diffused cover

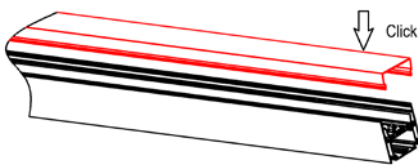

5. Fix the end caps with screws

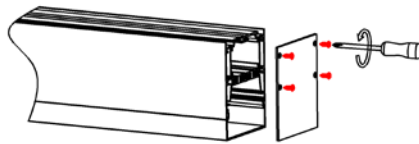

6. Click the outside clip for hanging

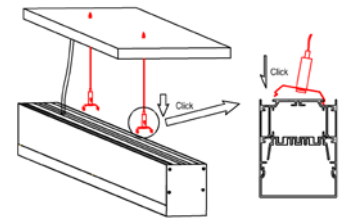

7. Adjust the hanging cord

