

Model : LS40-T

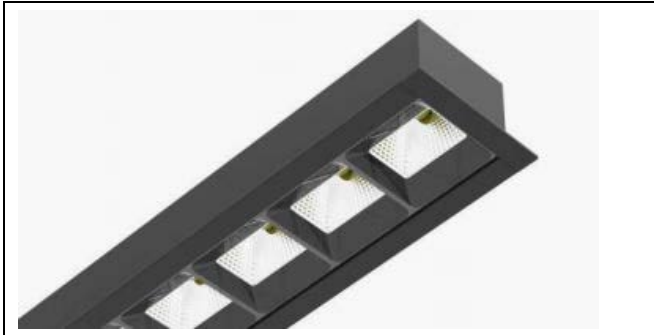

Dimension

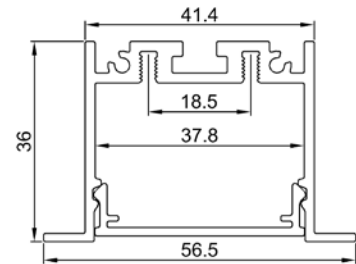

Specification

| | |
|---------------------|---|
| Aluminum Profile | 6063-T5 |
| Diffuser | PC frosted cover |
| Length | 2000mm / 2500mm / 3000mm |
| Weight | 0.838kg/m(Profile only) |
| Max LED Strip Width | 36mm |
| Max Power | 30W/m |
| Beam angle | 100° (PC frosted cover) |
| Finish | Silver / Black anodized , Powder coated white / black or other colors |
| Installation | Recessed(Trim) |

Accessories

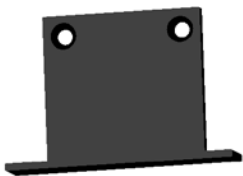

End Cap (Metal)



LED Module



PC Frosted Cover



Blind Aluminum Cover



Lens



Reflector

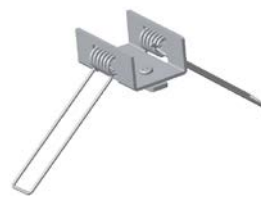

Spring Clip

Steps of Installation

1. Install the led module & base of reflector.

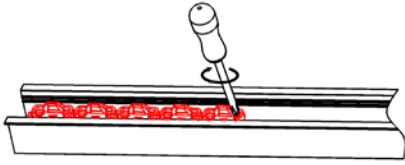

2. Press the reflector & blind cover

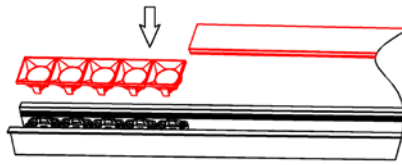

3. Install the spring clip parts

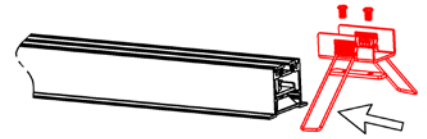

4. Fix the spring clip tightly with screws

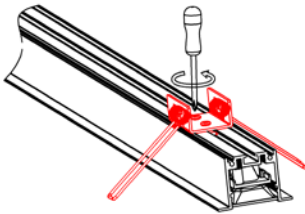

5. Fix the end caps with screws

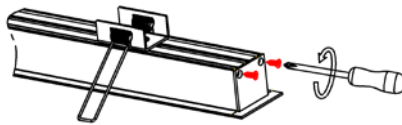

6. Mounting the fixture on the ceiling.

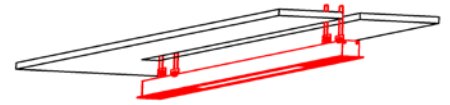

7. Installation completed .

